

GROEN ZUILEN

2005, Utrecht, The Netherlands

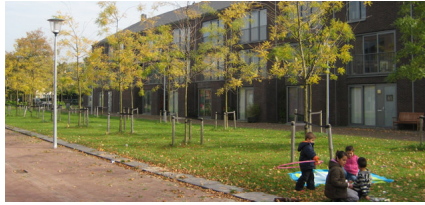

The plan for the public space of the new neighborhood Groen Zuilen combines the serenity and ambiance of a beguinage with a modern comfortable residential district.

The quiet green neighborhood is enclosed by a wide hedge of field maple's. The architect Machiel van der Torre has designed the dwellings with internal parking, hence reducing the amount of cars on the streets which provides a more tranquil feel to the area.

The two key internal public spaces are designed as avenues consisting of majestic trees (sophora and gleditsias) placed on a green carpet of grass. Both types of trees have a light translucent canopy which enhances the feeling of dappled light and space. The spring blossom and the coloration of the leaves in autumn give the neighborhood a strong sense of the seasons.

In addition to the avenues there is a village green which is surrounded by a hedge. It incorporates large trees, benches and two flower gardens planted with azaleas and hydrangea.

client

City of Utrecht, Woningcorporatie Mitros, Johan Matser Projectontwikkeling b.v., Bouwbedrijf Midreth b.v.

team

Edzo Bindels, Edwin van der Hoeven